

NOTE: *All As-built plan information from this office MUST be field verified for location and depth. The information provided from this office shall not be used in place of an actual survey.

| REVISIONS | | | | MEGAN M. TETRO, P.E. FLORIDA PE NO. 76120 WANTMAN GROUP, INC. 3111 W. MARTIN LUTHER KING JR. BLVD., SUITE 375, TAMPA, FL 33607 CERTIFICATE OF AUTHORIZATION NO. 6091 | TAMPA HILLSBOROUGH EXPRESSWAY AUTHORITY | | | SHEET NO. 4 |
|-----------|-------------|------|-------------|---|---|--------------|--------------|--------------------|
| DATE | DESCRIPTION | DATE | DESCRIPTION | | ROAD | COUNTY | CONTRACT NO. | |
| | | | | | TWIGGS | HILLSBOROUGH | 000419 | |

THE OFFICIAL RECORD OF THIS SHEET IS THE ELECTRONIC FILE DIGITALLY SIGNED AND SEALED UNDER RULE 61G15-23.004, F.A.C.

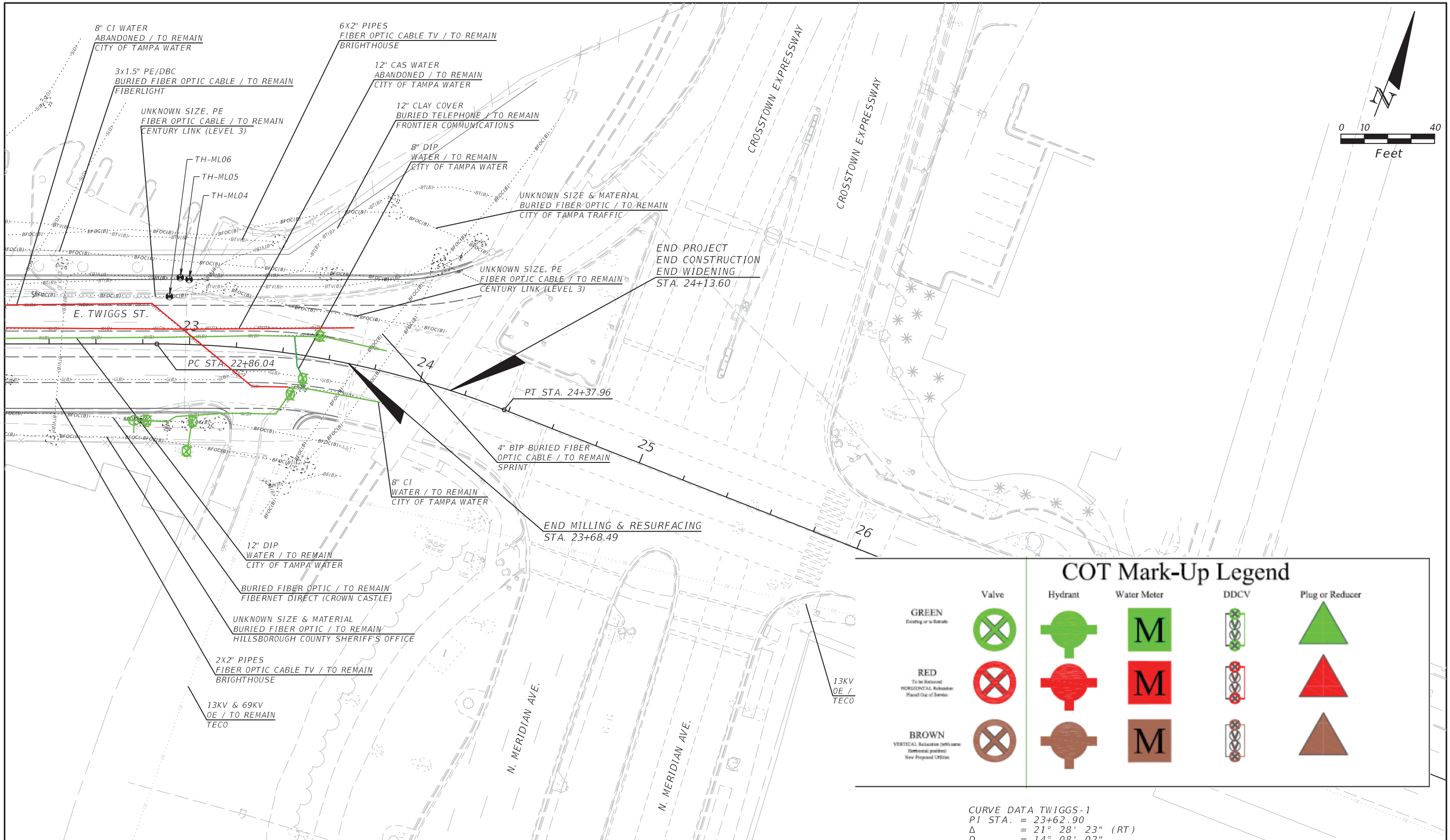

COT Mark-Up Legend

| Color | Valve | Hydrant | Water Meter | DDCV | Plug or Reducer |
|--|-------|---------|-------------|------|-----------------|
| GREEN <small>Existing or to Remain</small> | | | | | |
| RED <small>To be Removed HORIZONTAL Relocation Placed Out of Service</small> | | | | | |
| BROWN <small>VERTICAL Relocation (with same horizontal position) New Proposed Location</small> | | | | | |

CURVE DATA TWIGGS-1
 PI STA. = 23+62.90
 Δ = 21° 28' 23" (RT)
 D = 14° 08' 02"
 T = 76.87
 L = 151.93
 R = 405.38
 PC STA. = 22+86.04
 PT STA. = 24+37.96

NOTE: *All As-built plan information from this office MUST be field verified for location and depth.
 The information provided from this office shall not be used in place of an actual survey.

| REVISIONS | | | | MEGAN M. TETRO, P.E. FLORIDA PE NO. 76120 WANTMAN GROUP, INC. 3111 W. MARTIN LUTHER KING JR. BLVD., SUITE 375, TAMPA, FL 33607 CERTIFICATE OF AUTHORIZATION NO. 6091 | TAMPA HILLSBOROUGH EXPRESSWAY AUTHORITY | | | UTILITY ADJUSTMENT (2) | SHEET NO. 5 |
|-----------|-------------|------|-------------|---|--|--------------|--------------|-------------------------------|-----------------------|
| DATE | DESCRIPTION | DATE | DESCRIPTION | | ROAD | COUNTY | CONTRACT NO. | | |
| | | | | | TWIGGS | HILLSBOROUGH | 000419 | | |