

**DRAWING ACCURACY
WAS NOT VERIFIED.
FIELD VERIFY LOCATIONS
AND DEPTHS.**

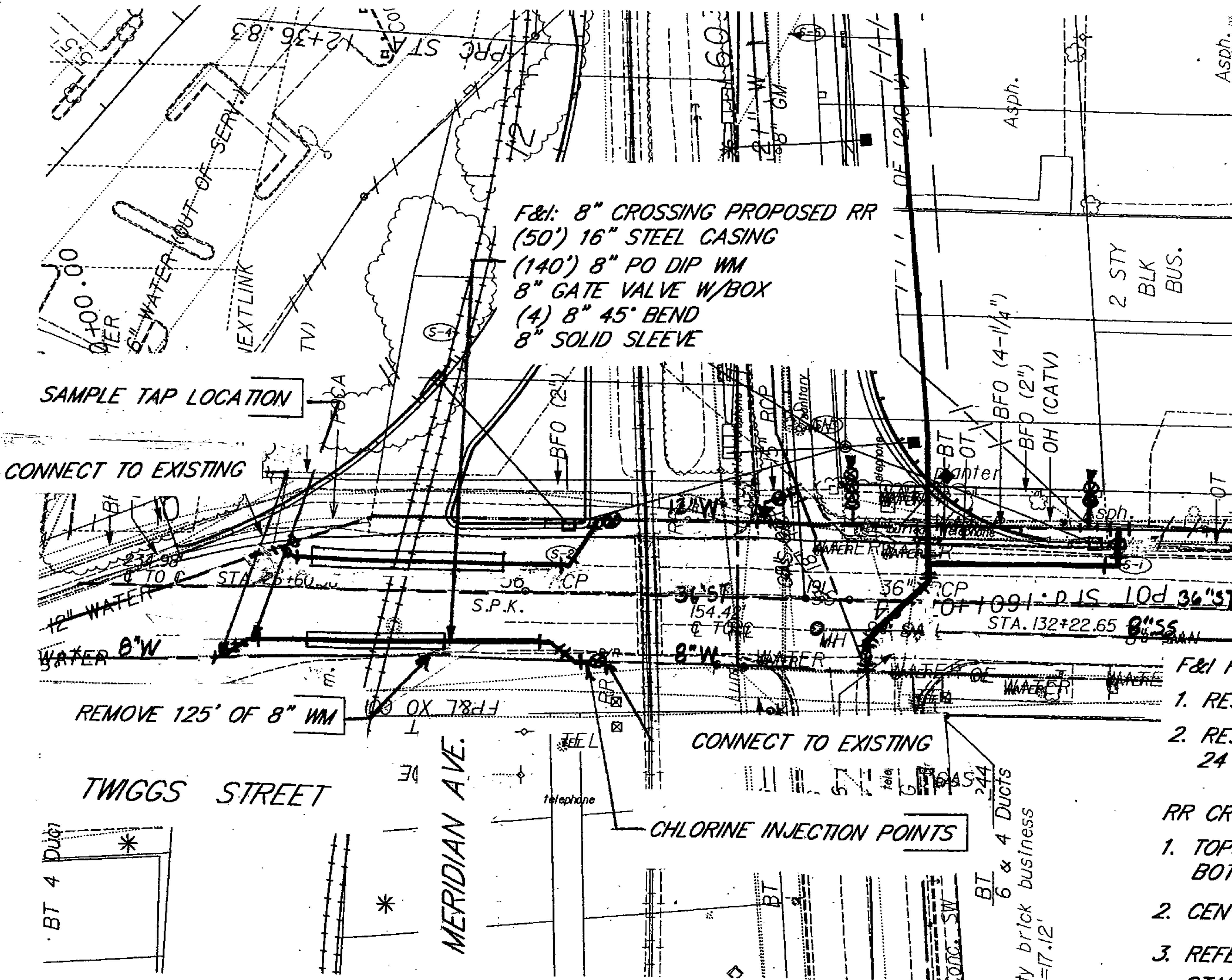

SEC.18,19-T28S-R19E
SCALE 1"=40'



F&I: 8" CROSSING PROPOSED RR
(50') 16" STEEL CASING
(140') 8" PO DIP WM
8" GATE VALVE W/BOX
(4) 8" 45° BEND
8" SOLID SLEEVE

- F&I RESTRAIN JOINT NOTES:**
1. RESTRAIN ALL NEW 8" PO & MJ JOINTS.
 2. RESTRAIN ALL EXISTING 8" MJ & PO JOINTS
24' EAST & 24' WEST OF CONNECTION TO EXISTING.

- RR CROSSING NOTES:**
1. TOPS OF CASING TO BE 5'6" BELOW PROPOSED
BOTTOM OF TRACKS.
 2. CENTER CASING AS SHOWN ON STANDARD DETAIL 2.04.
 3. REFERENCE CITY OF TAMPA WATER DEPARTMENT
STANDARD DETAIL 2.04.

CHRIS BARQUIN, P.E.
CITY OF TAMPA WATER DEPT.
306 E. JACKSON ST., 5E
TAMPA, FL 33602
P.E. #31900

8" DIP WM RAILROAD
CROSSING TWIGGS

CHRIS BARQUIN
FLA. P.E. # 31900

No.	Date	REVISION	By	Des: JRD	W.O. 6822	File: SELMON XTOWN
Approved Date	[Signature]			Dwn: JDM	FILE NUMBER	
				Ckd: GE	FC84-139G	
				SHEET TWD 10 OF TWD 18 SHEETS		