

**DRAWING ACCURACY
WAS NOT VERIFIED.
FIELD VERIFY LOCATIONS
AND DEPTHS.**

TWIGGS STREET

**PROPOSED 12"
WATER MAIN
(SEE SHEET 74)**

SEC. 24-T29S-R18E

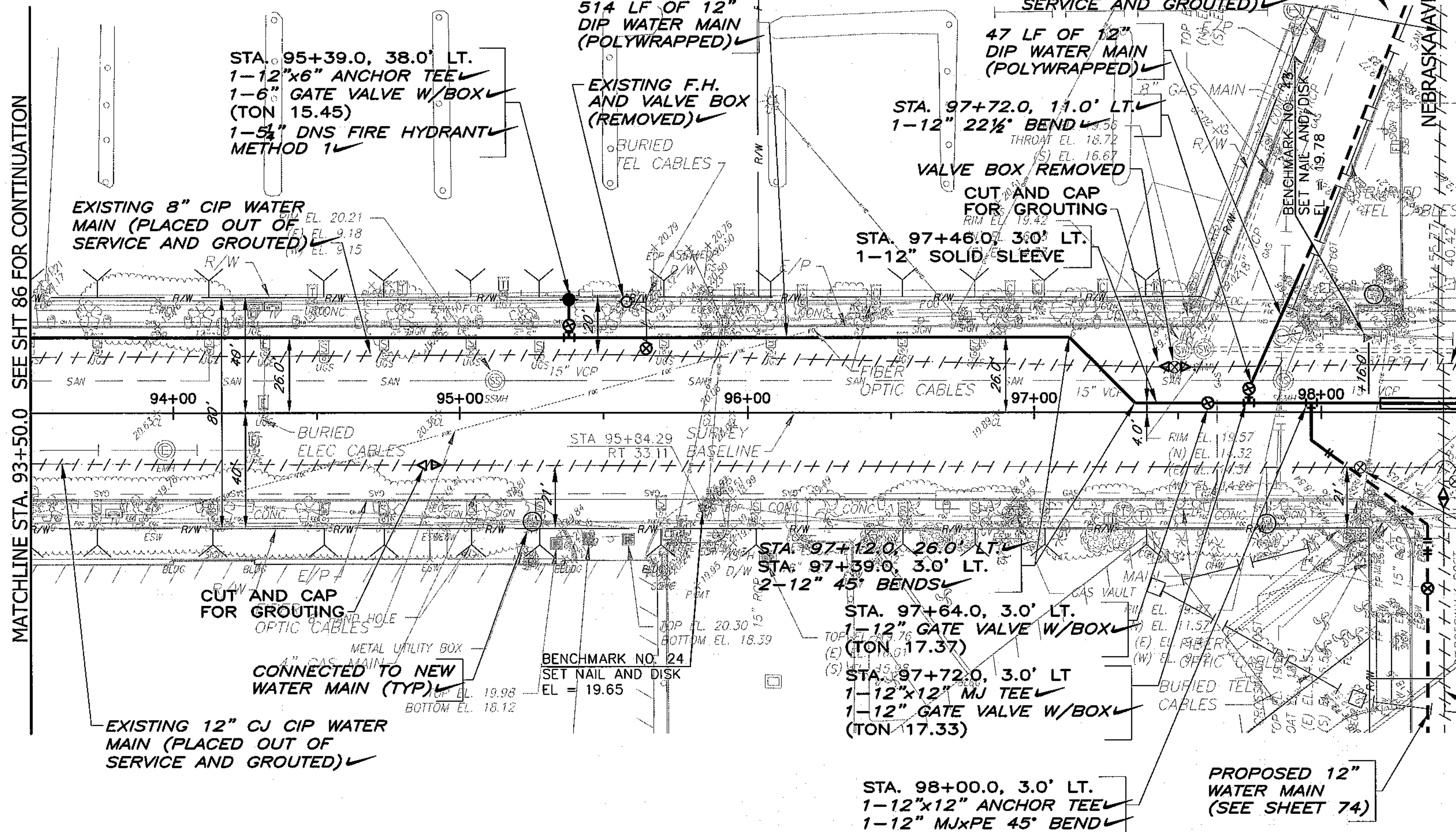

MATCHLINE STA. 93+50.0 SEE SHT 86 FOR CONTINUATION

MATCHLINE STA. 98+50.0 SEE SHT 90 FOR CONTINUATION

RECORD DRAWING LEGEND

PLAN

RECORD DRAWING



- SIGNIFIES COMPLETION AS DESIGNED
- STA. 12+19.1, 7.5' RT.** AS-BUILT INFORMATION (TEXT NOT SLANTED)
- PIPE PLACED OUT OF SERVICE

GREELEY AND HANSEN
1715 N. WESTSHORE BLVD., STE. 464
TAMPA, FLORIDA 33607
CERTIFICATE OF AUTHORIZATION NO. 37

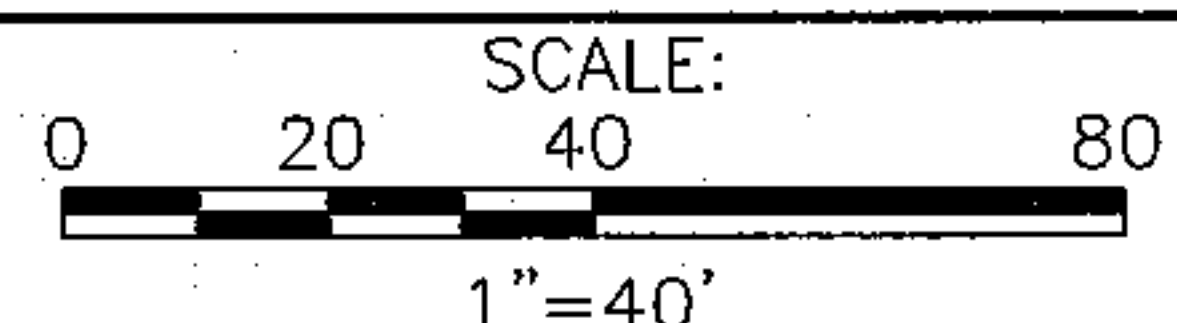

DESIGNED NAM, ML
DRAWN GAG
CHECKED TYW

NO.	DATE	APPD	REVISION
3	07/11	TYW	RECORD DRAWING REVISION
P.E. NAME: THOMAS Y. WILSON		P.E. NO. 40284	
P.E. NAME:		DATE:	

CITY OF TAMPA WATER DEPARTMENT
2008 WATER MAIN IMPROVEMENTS - DOWNTOWN PHASE C
PLAN
TWIGGS STREET
STA. 93+50.0 TO STA. 98+50.0



W.O. NO. 7042
FILE: DTCTESH04E
NO. **88** OF 134
DATE JULY 2011

NOTES:
1. LEAVE INDICATED VALVE
IN OPEN POSITION FOR
GROUTING.

SHT 88, 7/15/2011 11:58:30 AM

FCB4-450