

NOTES:

1. ELEVATION OF GAS MAIN UNKNOWN. VERIFY PRIOR TO CONSTRUCTION.

DRAWING ACCURACY WAS NOT VERIFIED. FIELD VERIFY LOCATIONS AND DEPTHS.

RESTRAIN EVERY PIPE JOINT (20 LF)

RESTRAIN EVERY PIPE JOINT (180 LF)

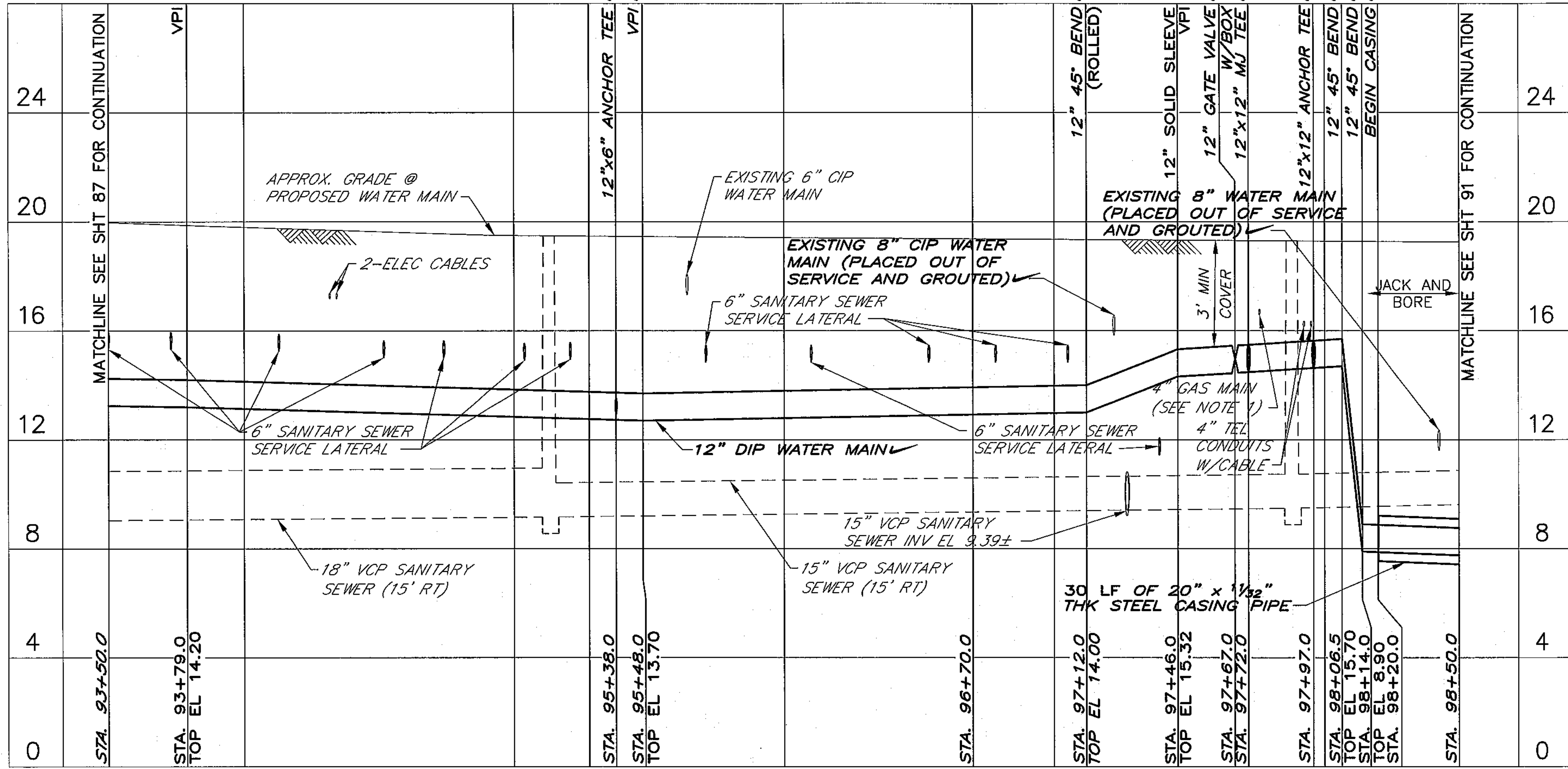

94+00 95+00 96+00 97+00 98+00

RECORD DRAWING LEGEND

PROFILE

THIS RECORD DRAWING IS NOT WARRANTED BUT IS BELIEVED TO REPRESENT CONDITIONS UPON COMPLETION OF CONSTRUCTION WITHIN REASONABLE TOLERANCES, BASED UPON THE INFORMATION FURNISHED TO THE ENGINEER FROM THE CONTRACTOR PERTAINING TO CHANGES MADE DURING CONSTRUCTION. STRIKE THROUGH OF THE ORIGINAL DESIGN/CALL-OUTS WERE NOT USED.



✓ SIGNIFIES COMPLETION AS DESIGNED
 STA. 12+19.1, 7.5' RT. AS-BUILT INFORMATION (TEXT NOT SLANTED)

GREELEY AND HANSEN
 1715 N. WESTSHORE BLVD., STE. 464
 TAMPA, FLORIDA 33607
 CERTIFICATE OF AUTHORIZATION NO. 37

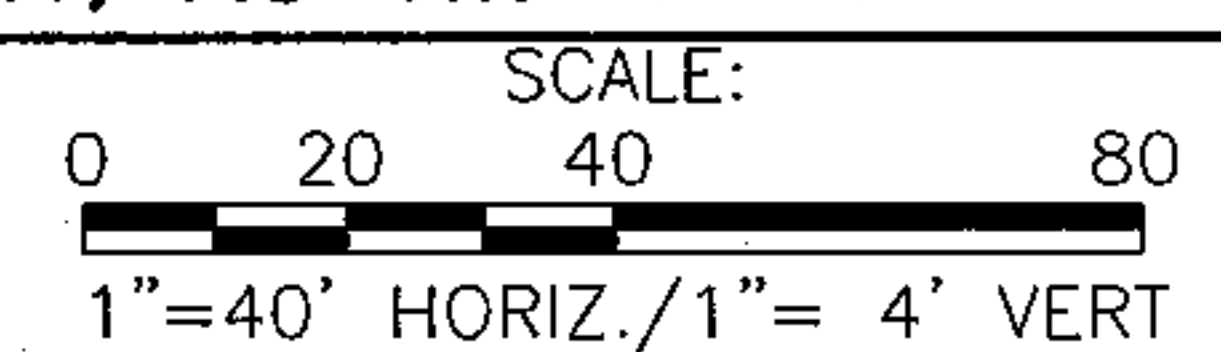

DESIGNED: NAM, ML
 DRAWN: GAG
 CHECKED: TYW

NO.	DATE	APPD	REVISION
1	07/11	TYW	RECORD DRAWING REVISIONS

P.E. NAME: THOMAS Y. WILSON P.E. NO. 40284
 P.E. NAME: _____
 DATE: _____

CITY OF TAMPA WATER DEPARTMENT
 2008 WATER MAIN IMPROVEMENTS - DOWNTOWN PHASE C
 PROFILE
 TWIGGS STREET
 STA. 93+50.0 TO STA. 98+50.0



W.O. NO. 7042
 FILE: DTCTESH05E
 NO. 89 OF 134
 DATE JULY 2011

SHT 89, 7/15/2011 12:01:35 PM

FCB4-451